

### Wiring Diagram

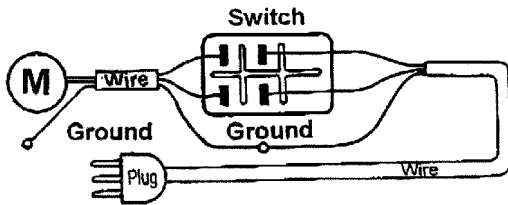

Issue: 1  
 Date: 140306

### Assembly Diagram and Parts List

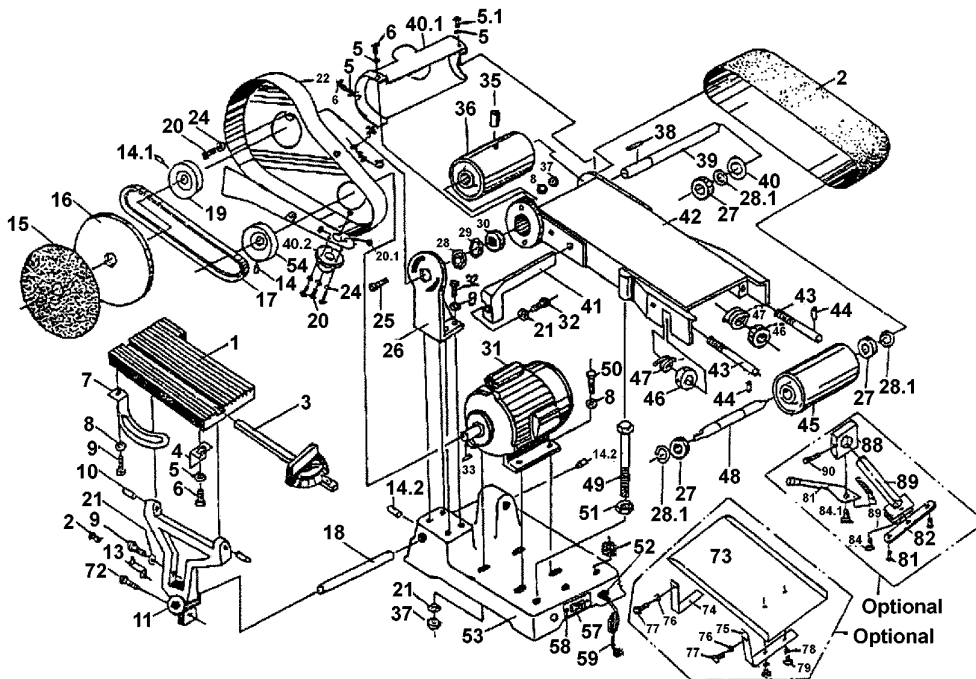

Item	Part No.	Description	Item	Part No.	Description	Item	Part No.	Description
1	SM15C/01	TABLE (SO)	29	SM15C/29	C SNAP RING S35	58	SM15C/58	P H SCREW
2.1	SM15/B080G	BELT, 80G 150X1220mm	30	B/620ZZ-NR	BEARING, 620ZZZ WITH GROOVE	59	SM15C/59	POWER CORD
2.2	SM15/B100G	BELT, 100G 150X1220mm	31	SM15C/31	MOTOR	60	SM15C/60	ROLLER ADJUST BODY
3	SM15C/03	MITRE GAUGE	32	SM15C/32	SCREW M8X25	61	SM15C/61	STAND
4	SM15C/04	TABLE MOUNT	33	SM15C/33	KEY 5X5X20	62	SM15C/62	STAND PLATE
5	SM15C/05	WASHER 5MM	34	SM15C/34	TUBE	63	SM15C/63	SCREW M8X12
6	SM15C/06	PAN SCREW M5X10	35	SM15C/35	SET SCREW M8X20	64	SM15C/64	RUBBER
7	SM15C/07	ANGLE GAUGE	36	SM15C/36	DRIVING ROLLER	65	SM15C/65	WASHER 8MM
8	SM15C/08	WASHER 8MM	37	SM15C/37	NUT M8	66	SM15C/66	SCREW M8X10
9	SM15C/09	SCREW M8X20	38	SM15C/38	KEY B5X30	67	SM15C/67	NUT M8
10	SM15C/10	PIN	39	SM15C/39	DRIVING ROLLER SHAFT	68	SM15C/68	NUT M8
11	SM15C/11	TABLE SUPPORT BRACKET	40	M15C/40	SAFETY COVER	69	SM15C/69	FRAME
12	SM15C/12	SCREW M8x16	40.1	SM15C/40.2	DISC DUST CHUTE	70	SM15C/70	WASHER 8MM
13	SM15C/13	POINTER	41	SM15C/41	BACK STOP	71	SM15C/71	SCREW M8X12
14	SM15C/14	SET SCREW M8X12	42	SM15C/42	SAND BELT FRAME (SO)	72	SM15C/72	SET SCREW M8
15	SM15/D80G	DISC, 80GØ250MM	43	SM15C/43	ROLLER ADJUST BAR	73	SM15C/73	PLATE
16	SM15C/16	SAND DISC	44	SM15C/44	SPRING PIN	74	SM15C/74	SUPPORT
17	SM15C/17	USE V/A25 V BELT	45	SM15C/45	IDLER ROLLER	75	SM15C/75	SUPPORT (SO)
18	SM15C/18	SUPPORT BAR	46	SM15C/46	KNOB	76	SM15C/76	WASHER 8mm (SO)
19	SM15C/19	PULLLEY 15MM	47	SM15C/47	SUPPORTING SHAFT	77	SM15C/77	SCREW M8X12 (SO)
20	SM15C/20	SCREW, M8 X 12 HEX HEAD SET BZP	48	SM15C/48	IDLER ROLLER SHAFT	78	SM15C/78	WASHER 6MM
21	SM15C/21	SPRING WASHER 8MM	49	SM15C/49	SUPPORT BOLT M16X220	79	SM15C/79	KNOB
22	SM15C/22	PULLEY COVER	50	SM15C/50	BOLT M8 * 30	80	SM15C/80	WASHER 5MM
23	SM15C/23	SCREW M8X35	51	SM15C/51	NUT M16	81	SM15C/81	PAN SCREW M5X16
24	SM15C/24	WASHER 5MM	52	SM15C/52	CORD CLAMP	82	SM15C/82	ROCKER SHAFT
25	SM15C/25	SCREW M5x10	53	SM15C/53	BASE	83	SM15C/83	ROCK ARM
26	SM15C/26	BRACKET	54	SM15C/54	PULLEY 16MM	84	SM15C/84	KNOB
27	SM15C/27	USE B/6201Z (BEARING)	55	SM15C/55	HEX WRENCH	88	SM15C/88	NUT M10
28	SM15C/28	RETAINING RING S15	56	SM15C/56	HEX WRENCH	89	SM15C/89	TUBE
			57	SM15C/57	SWITCH			