



Instructions For: **REMOTE THERMOSTAT FOR
AB CHIMNEY HEATERS**
MODEL: **ABT04**

Thank you for purchasing a Sealey Product. Manufactured to a high standard this product will, if used according to these instructions and properly maintained, give you years of trouble free performance.



IMPORTANT: PLEASE READ THESE INSTRUCTIONS CAREFULLY. NOTE THE SAFE OPERATIONAL REQUIREMENTS, WARNINGS AND CAUTIONS. USE THIS PRODUCT CORRECTLY AND WITH CARE FOR THE PURPOSE FOR WHICH IT IS INTENDED. FAILURE TO DO SO MAY CAUSE DAMAGE AND/OR PERSONAL INJURY, AND WILL INVALIDATE THE WARRANTY. PLEASE KEEP INSTRUCTIONS SAFE FOR FUTURE USE.

1. SAFETY INSTRUCTIONS

1.1. ELECTRICAL SAFETY

WARNING! It is the responsibility of the owner and the operator to read, understand and comply with the following: You must check all electrical products, before use, to ensure that they are safe. You must inspect power cables, plugs, sockets and any other connector for wear or damage. You must ensure that the risk of electric shock is minimised by the installation of appropriate safety devices. A Residual Current Circuit Breaker (RCCB) should be incorporated in the main distribution board. We also recommend that a Residual Current Device (RCD) is used. It is particularly important to use an RCD with portable products that are plugged into a supply which is not protected by an RCCB. If in any doubt consult a qualified electrician. You may obtain a Residual Current Device by contacting your Sealey dealer.

You must also read and understand the following instructions concerning electrical safety.

- 1.1.1. The **Electricity at Work Act 1989** requires all portable electrical appliances, if used on business premises, to be tested by a qualified electrician, using a Portable Appliance Tester (PAT), at least once a year.
- 1.1.2. The **Health & Safety at Work Act 1974** makes owners of electrical appliances responsible for the safe condition of those appliances and the safety of the appliance operators. **If in any doubt about electrical safety, contact a qualified electrician.**
- 1.1.3. Ensure that the insulation on all cables and on the appliance is safe before connecting it to the power supply. See 1.1.1. and 1.1.2. and use a Portable Appliance Tester.
- 1.1.4. Ensure that cables are always protected against short circuit and overload.
- 1.1.5. Regularly inspect power supply cables and plugs for wear or damage and check all connections to ensure that none is loose.
- 1.1.6. **Important:** Ensure that the voltage marked on the appliance matches the power supply to be used and that the plug is fitted with the correct fuse. See your heater manual for the correct fuse.
- 1.1.7. **DO NOT** pull or carry the appliance by the power cable.
- 1.1.8. **DO NOT** pull the plug from the socket by the cable.
- 1.1.9. **DO NOT** use worn or damaged cables, plugs or connector. Immediately have any faulty item repaired or replaced by a qualified electrician.

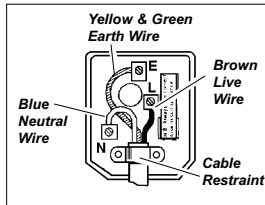

1.2. GENERAL SAFETY

- ✓ Check that the heater is in sound condition and good working order. *Take immediate action to repair or replace damaged parts.*
- ✓ Use recommended parts only. *Unapproved parts may be dangerous and will invalidate the warranty.*
- WARNING!** Only use heater in well ventilated areas. Ensure continuous ventilation is provided to the heater operating area. If your operating area has no direct access to clean fresh air we recommend that you run a large gauge duct from the outside of the building to the back of the heater in order to provide a clean air intake.
- ✓ Keep the heater a minimum of 3 meters from any combustible materials (i.e. wooden items, cloth, plastics, paper, etc).
- ✓ Maintain a minimum distance of 50cm from non-combustible materials (i.e. brick, steel, concrete, etc).
- ✓ Maintain the following clearances around the heater. Sides - 0.6m, Top - 1.5m, Air inlet - 0.6m, Air outlet - 3.0m

For all other heater safety see your heater instructions.

2. INTRODUCTION

Thermostat with a setting range of 5°-30° and On/Off switch gives complete control over remotely positioned heater. Supplied with 10mtr cable and plug for direct connection to heater. Suitable for use with AB502, AB902, AB1452, AB125HE and AB180HE heaters.



ABT04 - 1 - 101104



Instructions For: **REMOTE THERMOSTAT FOR
AB CHIMNEY HEATERS**
MODEL: **ABT04**

Thank you for purchasing a Sealey Product. Manufactured to a high standard this product will, if used according to these instructions and properly maintained, give you years of trouble free performance.



IMPORTANT: PLEASE READ THESE INSTRUCTIONS CAREFULLY. NOTE THE SAFE OPERATIONAL REQUIREMENTS, WARNINGS AND CAUTIONS. USE THIS PRODUCT CORRECTLY AND WITH CARE FOR THE PURPOSE FOR WHICH IT IS INTENDED. FAILURE TO DO SO MAY CAUSE DAMAGE AND/OR PERSONAL INJURY, AND WILL INVALIDATE THE WARRANTY. PLEASE KEEP INSTRUCTIONS SAFE FOR FUTURE USE.

1. SAFETY INSTRUCTIONS

1.1. ELECTRICAL SAFETY

WARNING! It is the responsibility of the owner and the operator to read, understand and comply with the following: You must check all electrical products, before use, to ensure that they are safe. You must inspect power cables, plugs, sockets and any other connector for wear or damage. You must ensure that the risk of electric shock is minimised by the installation of appropriate safety devices. A Residual Current Circuit Breaker (RCCB) should be incorporated in the main distribution board. We also recommend that a Residual Current Device (RCD) is used. It is particularly important to use an RCD with portable products that are plugged into a supply which is not protected by an RCCB. If in any doubt consult a qualified electrician. You may obtain a Residual Current Device by contacting your Sealey dealer.

You must also read and understand the following instructions concerning electrical safety.

- 1.1.1. The **Electricity at Work Act 1989** requires all portable electrical appliances, if used on business premises, to be tested by a qualified electrician, using a Portable Appliance Tester (PAT), at least once a year.
- 1.1.2. The **Health & Safety at Work Act 1974** makes owners of electrical appliances responsible for the safe condition of those appliances and the safety of the appliance operators. **If in any doubt about electrical safety, contact a qualified electrician.**
- 1.1.3. Ensure that the insulation on all cables and on the appliance is safe before connecting it to the power supply. See 1.1.1. and 1.1.2. and use a Portable Appliance Tester.
- 1.1.4. Ensure that cables are always protected against short circuit and overload.
- 1.1.5. Regularly inspect power supply cables and plugs for wear or damage and check all connections to ensure that none is loose.
- 1.1.6. **Important:** Ensure that the voltage marked on the appliance matches the power supply to be used and that the plug is fitted with the correct fuse. See your heater manual for the correct fuse.
- 1.1.7. **DO NOT** pull or carry the appliance by the power cable.
- 1.1.8. **DO NOT** pull the plug from the socket by the cable.
- 1.1.9. **DO NOT** use worn or damaged cables, plugs or connector. Immediately have any faulty item repaired or replaced by a qualified electrician.

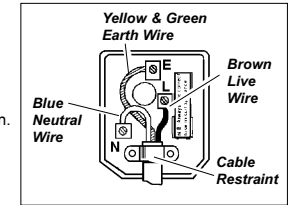

1.2. GENERAL SAFETY

- ✓ Check that the heater is in sound condition and good working order. *Take immediate action to repair or replace damaged parts.*
- ✓ Use recommended parts only. *Unapproved parts may be dangerous and will invalidate the warranty.*
- WARNING!** Only use heater in well ventilated areas. Ensure continuous ventilation is provided to the heater operating area. If your operating area has no direct access to clean fresh air we recommend that you run a large gauge duct from the outside of the building to the back of the heater in order to provide a clean air intake.
- ✓ Keep the heater a minimum of 3 meters from any combustible materials (i.e. wooden items, cloth, plastics, paper, etc).
- ✓ Maintain a minimum distance of 50cm from non-combustible materials (i.e. brick, steel, concrete, etc).
- ✓ Maintain the following clearances around the heater. Sides - 0.6m, Top - 1.5m, Air inlet - 0.6m, Air outlet - 3.0m

For all other heater safety see your heater instructions.

2. INTRODUCTION

Thermostat with a setting range of 5°-30° and On/Off switch gives complete control over remotely positioned heater. Supplied with 10mtr cable and plug for direct connection to heater. Suitable for use with AB502, AB902, AB1452, AB125HE and AB180HE heaters.



ABT04 - 1 - 101104

3. INSTALLATION

❑ **WARNING!** Before connecting the thermostat, make sure that the power supply to the heater **is not connected**.

3.1 Placement of the thermostat.

Note: The thermostat should be placed in a position away from doors, windows and approx 1.5mtr from the floor.

- 3.1.1 Remove the front cover from the thermostat base by releasing the clip using a screwdriver (fig.2).
- 3.1.2 Remove the breakout from the base using a suitable pair of pliers to allow the cable to recess the base. This will enable the base to sit flush against the wall.
- 3.1.3 Fix the base to the wall using the provided holes and secure it by means of suitable screws.
- 3.1.4 Replace the cover.

fig.1.

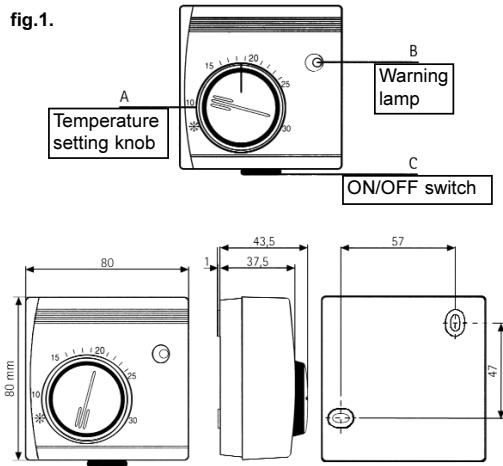
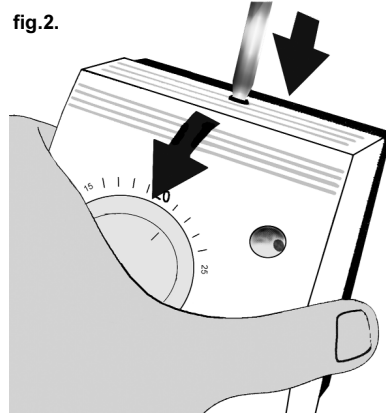
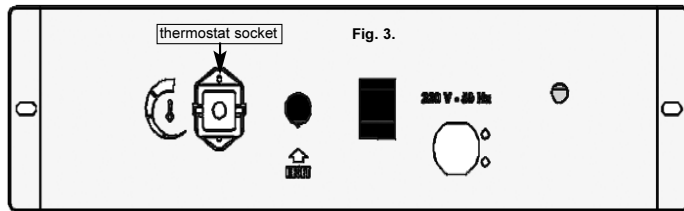

fig.2.



4. OPERATION

- 4.1 Install the thermostat by removing the socket cover on the heater panel (Fig. 3.) and inserting the thermostat plug into the socket.
- 4.1.1 Plug the heater into the mains socket (230V ~ 50Hz single phase). **(THE HEATER MUST BE EARTHED.)**
- 4.1.2 Set the thermostat ON/OFF switch to ON (Fig.1.c) and the temperature knob (Fig.1.a) to maximum and start the heater.
- 4.1.3 When the heater is running you may adjust the temperature by rotating the temperature knob to the desired temperature.
- 4.1.4 To turn off your AB heater, switch off the thermostat and follow your heater's instructions to shut down the heater.



NOTE: It is our policy to continually improve products and as such we reserve the right to alter data, specifications and component parts without prior notice.

IMPORTANT: No liability is accepted for incorrect use of this product.

WARRANTY: Guarantee is 12 months from purchase date, proof of which will be required for any claim.

INFORMATION: For a copy of our latest catalogue and promotions call us on 01284 757525 and leave your full name and address, including postcode.

Declaration of Conformity We, the sole importer into the UK, declare that the product listed below is in conformity with the following EEC standards and directives.

REMOTE THERMOSTAT FOR AB HEATERS
Model ABT04
89/336/EEC EMC Directive
93/68/EEC CE Marking Directive

CE Signed by Mark Sweetman 1st November 2004
For Jack Sealey Ltd. Sole importer into the UK of Sealey Power Tools.



Sole UK Distributor
Sealey Group,
Bury St. Edmunds, Suffolk.

01284 757500
01284 703534

Web address: www.sealey.co.uk
E-mail: sales@sealey.co.uk

3. INSTALLATION

❑ **WARNING!** Before connecting the thermostat, make sure that the power supply to the heater **is not connected**.

3.1 Placement of the thermostat.

Note: The thermostat should be placed in a position away from doors, windows and approx 1.5mtr from the floor.

- 3.1.1 Remove the front cover from the thermostat base by releasing the clip using a screwdriver (fig.2).
- 3.1.2 Remove the breakout from the base using a suitable pair of pliers to allow the cable to recess the base. This will enable the base to sit flush against the wall.
- 3.1.3 Fix the base to the wall using the provided holes and secure it by means of suitable screws.
- 3.1.4 Replace the cover.

fig.1.

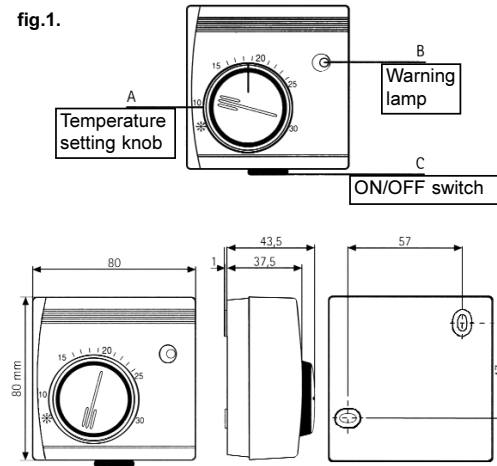
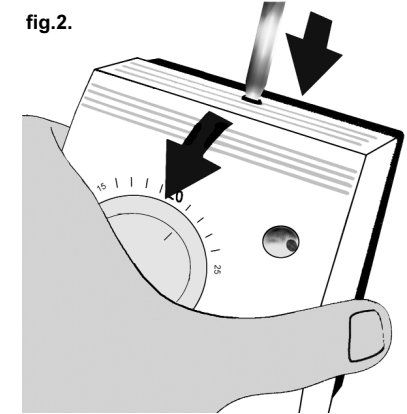
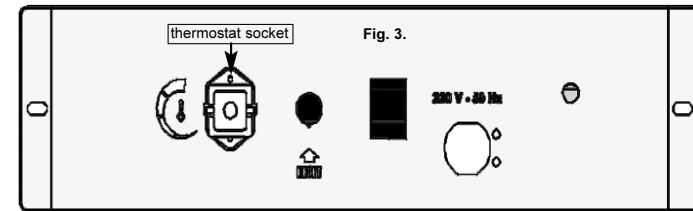

fig.2.



4. OPERATION

- 4.1 Install the thermostat by removing the socket cover on the heater panel (Fig. 3.) and inserting the thermostat plug into the socket.
- 4.1.1 Plug the heater into the mains socket (230V ~ 50Hz single phase). **(THE HEATER MUST BE EARTHED.)**
- 4.1.2 Set the thermostat ON/OFF switch to ON (Fig.1.c) and the temperature knob (Fig.1.a) to maximum and start the heater.
- 4.1.3 When the heater is running you may adjust the temperature by rotating the temperature knob to the desired temperature.
- 4.1.4 To turn off your AB heater, switch off the thermostat and follow your heater's instructions to shut down the heater.



NOTE: It is our policy to continually improve products and as such we reserve the right to alter data, specifications and component parts without prior notice.

IMPORTANT: No liability is accepted for incorrect use of this product.

WARRANTY: Guarantee is 12 months from purchase date, proof of which will be required for any claim.

INFORMATION: For a copy of our latest catalogue and promotions call us on 01284 757525 and leave your full name and address, including postcode.

Declaration of Conformity We, the sole importer into the UK, declare that the product listed below is in conformity with the following EEC standards and directives.

REMOTE THERMOSTAT FOR AB HEATERS
Model ABT04
89/336/EEC EMC Directive
93/68/EEC CE Marking Directive

CE Signed by Mark Sweetman 1st November 2004
For Jack Sealey Ltd. Sole importer into the UK of Sealey Power Tools.



Sole UK Distributor
Sealey Group,
Bury St. Edmunds, Suffolk.

01284 757500
01284 703534

Web address: www.sealey.co.uk
E-mail: sales@sealey.co.uk